

Quick Guide



Thank you for choosing

Addon Device - Asante Garage Door Opener with Camera

This guide assumes that you have already purchased an Asante Smart Home kit and Asante Home Extender is installed and running. If you have not setup your kit, please do so before installing this product. Refer to Quick Guide that was accompanied with your kit or visit www.asante.com.

For first time installation, please make sure that Asante Garage Door Opener with Camera and your Asante Home Extender are within close proximity to each other. Once claimed, it can be moved to proper location for installation. **If you have more than one Garage Door Opener with Camera, it is very important to add them one at a time.** Connect power, claim the device on the app and then move on to the next.



Asante Garage Door Opener ports and lights

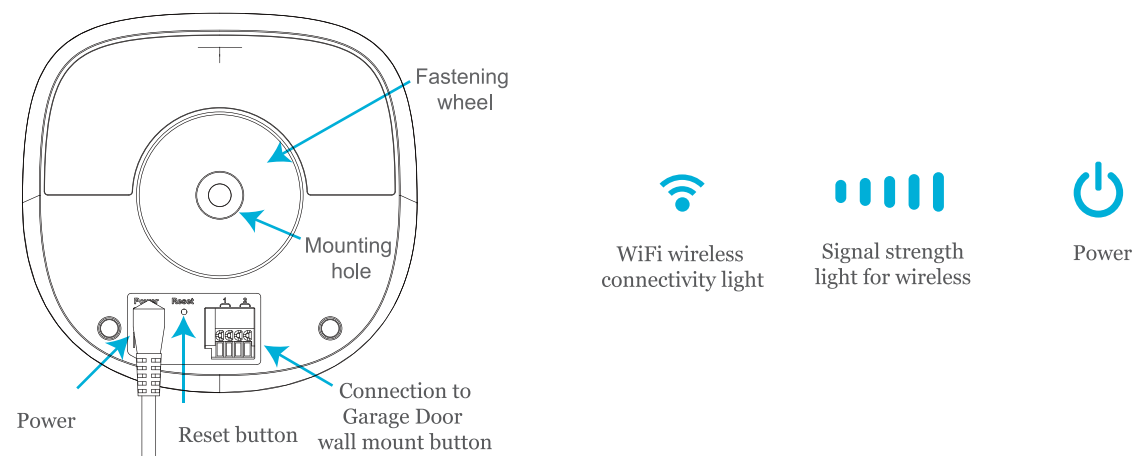

Step 1 Setup of Garage Door Opener with Camera

1. Connect the power to your new Asante Garage Door Opener with Camera.
2. LED lights on Asante Garage Door Opener with Camera will start to blink indicating WiFi pairing with Asante Home Extender.
3. Asante Home Extender pairing light will blink until the wireless connection has been established.
4. Claim your Garage Door Opener with Camera when prompted in the app.
5. Disconnect the power and move it to your desired location to prepare for installation.

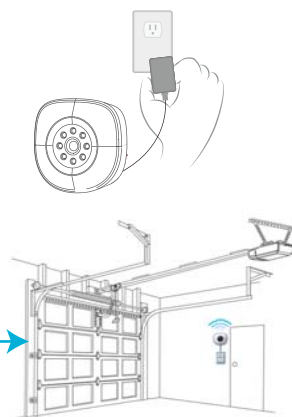

Step 2 Attaching Garage Door Opener with Camera to your current garage door wall mount button

! We recommend to unplug your garage door electric motor from the AC power during this installation.

Each Garage Door Opener with Camera can control up to **two** garage doors.

1. Using one set of wires (provided), insert tips into the green connector.

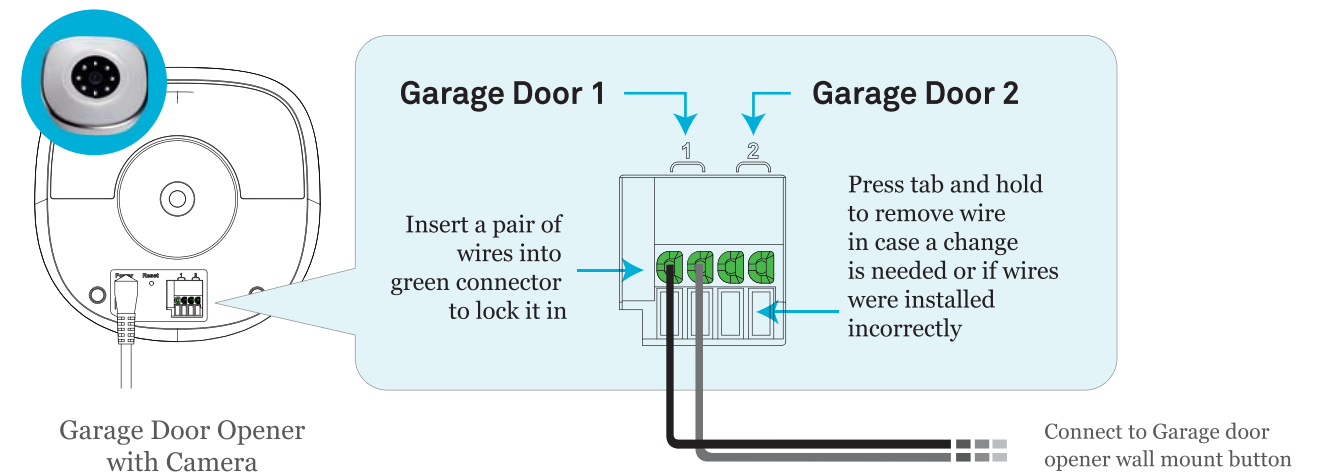

2. Connect the other side of wires to garage door opener's wall mount button (see orange arrow below).
Note that the wires from Garage Door Opener with Camera need to coexist with previous wires that were attached to the garage door motor.

For wiring instruction of wall mount button please see **"Wall Mount Buttons Reference Guide"**.

(One pair of wire needed for one door)

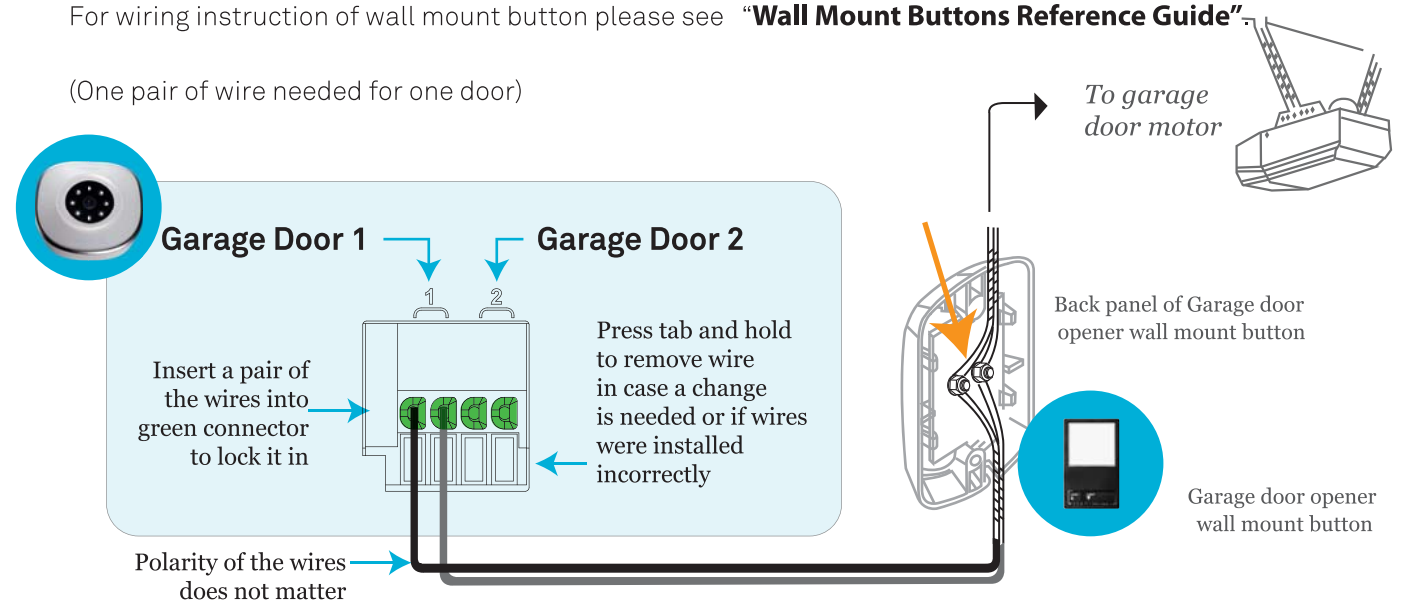

3. Reconnect the power to your garage door motor and to Asante Garage Door Opener with Camera.
4. Wait until the WiFi lights on Garage Door Opener with Camera are established.
5. **Before mounting the Garage Door Opener with Camera at desired location, login to app and make sure you can see the video.** Also press the button to see if the garage door can be closed or opened.



This concludes the installation of Garage Door Opener with Camera.

Step 6 Mounting instruction for Garage Door Opener with Camera

1. Hold the mounting base against the wall and mark the screw holes using a pen. Pay close attention to make sure the camera's location can cover your garage doors. Using the screws provided attach the base to the wall (Fig 1).
2. With wires connected to the Garage Door Opener with Camera, attach the camera to the base. To fasten, you need to turn the screw knob clockwise.(Fig 2)
3. To pan or tilt the the camera, hold the camera, pull gently and move it (excessive pull and twisting will damage the mounting unit).

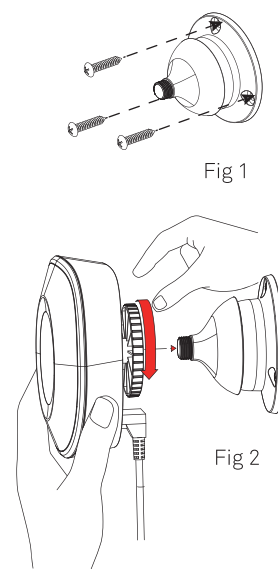

Step 7 WiFi setup for Asante Home Extender (Optional)

Asante Home Extender wireless bridge mode can extend your wireless coverage in a large size property. For areas larger than 5000 sq.ft, consider placing the Asante Home Extender in a central location to bridge Asante devices into your home router. Otherwise we strongly recommend using the Ethernet wired mode. If you still want to use the wireless option, please follow the procedure below.

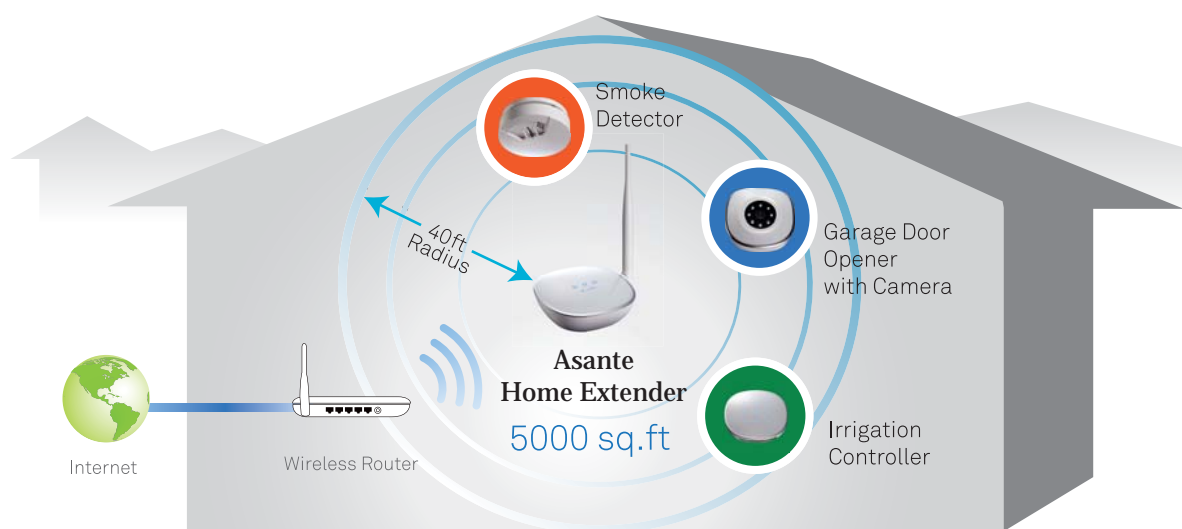

Use wireless connection to maximize the WiFi coverage. Asante Home Extender can cover up to 5000 sq.ft

1. Login to app and select the settings button as shown below
2. Select WiFi manager
3. Select your home router from the list
4. Enter your personal wireless password that has been setup on your router when prompted

Once connected, you can disconnect the Ethernet cable between the Asante Home Extender and router and move the Asante Home Extender to appropriate location. The lights on the Asante Home Extender indicate a wireless signal.

